

**Notes:**

- All drawings to be read in conjunction with all relevant Architects drawings and specifications.
- All levels are in metres unless shown otherwise.
- Do not scale. Use figured dimensions only.
- All drainage details are to comply with the requirements of Kildare County Council Water Services Department and Irish Water requirements as detailed in the following documents:
  - (i) Code of Practice for Wastewater Infrastructure, Connections and Developer Services.
  - (ii) Wastewater Infrastructure Standard Details, Connections and Developer Services.
  - (iii) Code of Practice for Water Infrastructure, Connections and Developer Services.
  - (iv) Water Infrastructure Standard Details, Connections and Developer Services.
- All on plot private drainage (not shown) to be in accordance with Building Regulations Technical Guidance Document H.
- Gullies will be provided at a maximum of every 200 square metres of paved surface
- Network details indicated may vary.
- All sewer pipe material types to be approved by Irish Water with the preferred material type Unplasticised PVC or Thermoplastic Structured Wall pipes and fittings in accordance with CI 3.13 of the Code of Practice for Wastewater Infrastructure

comply with the provisions of IS EN 13476 (2007/2009). Pipes to be of Stiffness Class 8kN/m<sup>2</sup> and to be capable of demonstrating a jetting resistance of 2,600 psi (180 Bar) without damage when tested in accordance with Section 3.3 of WIS 4-35-01 (2008). (Sewer diameters 150mm up to 450mm, Service Connections of 100mm diameter);

3.13.3 **Unplasticised PVC**; Unplasticised PVC pipes and fittings shall comply with the provisions IS EN 1401 2009/2012. Pipes to be application area code 'UD', Stiffness Class 8kN/m<sup>2</sup>. Provision for jetting shall be based on the WRc Sewer Jetting Code of Practice, June 1997. Pipes to be capable of resisting a maximum jetting pump pressure of 2,600psi (180 Bar) without damage. (Sewer diameters 150mm up to 450mm, Service Connections of 100mm diameter);

9. All sewer Pipe joints shall be in accordance with the manufacturer's instructions for the pipe material.

10. All water mains material types to be approved by Irish Water with the preferred material type HDPE or MDPE in accordance CI 3.9 of Code of Practice for Water Infrastructure;

3.9.2 **MDPE and HDPE** pipes shall be of a type PE-80 and have an SDR-11 or SDR-17 rating. They shall conform to IS EN 12201: Part 1 and Part 2 (Plastic Systems for Water Supply, Drainage and Sewerage Under Pressure - Part 1, General and Part 2, Pipes) and IS EN 12201-3 (Plastic Systems for Water Supply, Drainage and Sewerage Under Pressure - Part 3, Fittings).

11. All Water Main Pipe joints shall be in accordance with the manufacturer's instructions for the pipe material. Refer to IW Standard Details STD-W-04, 05, 06, 07, 08, 09 & 10 for full details.

**New External Concrete Slab and Footpath Specification:**

- Use concrete with a compressive strength class C30/37 Maximum water cement ratio 0.55. Minimum cement content 340kg/m<sup>3</sup>. Air entrainment 4.0%. Brush finish. Mix designed to meet the freeze thaw exposure class requirements XF3 given in Table N.A. 6 of IS-EN 206 for horizontal concrete surfaces.
  - 1.1. Slab thickness: 150mm
  - 1.2. Reinforcement: Layer of A252 mesh top
  - 1.3. Minimum cover: 50mm
- Sand blinding on 225mm thk compacted crushed stone to Annex E of S.R. 21
- On a geotextile layer on a solid formation.
- Movement joints in the form of contraction joints and isolation joints are to be provided at the locations shown on the layout plan.

3.13.2 **Thermoplastic Structured Wall Pipes**; Thermoplastic structured wall pipes shall

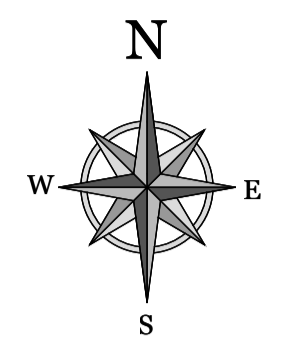
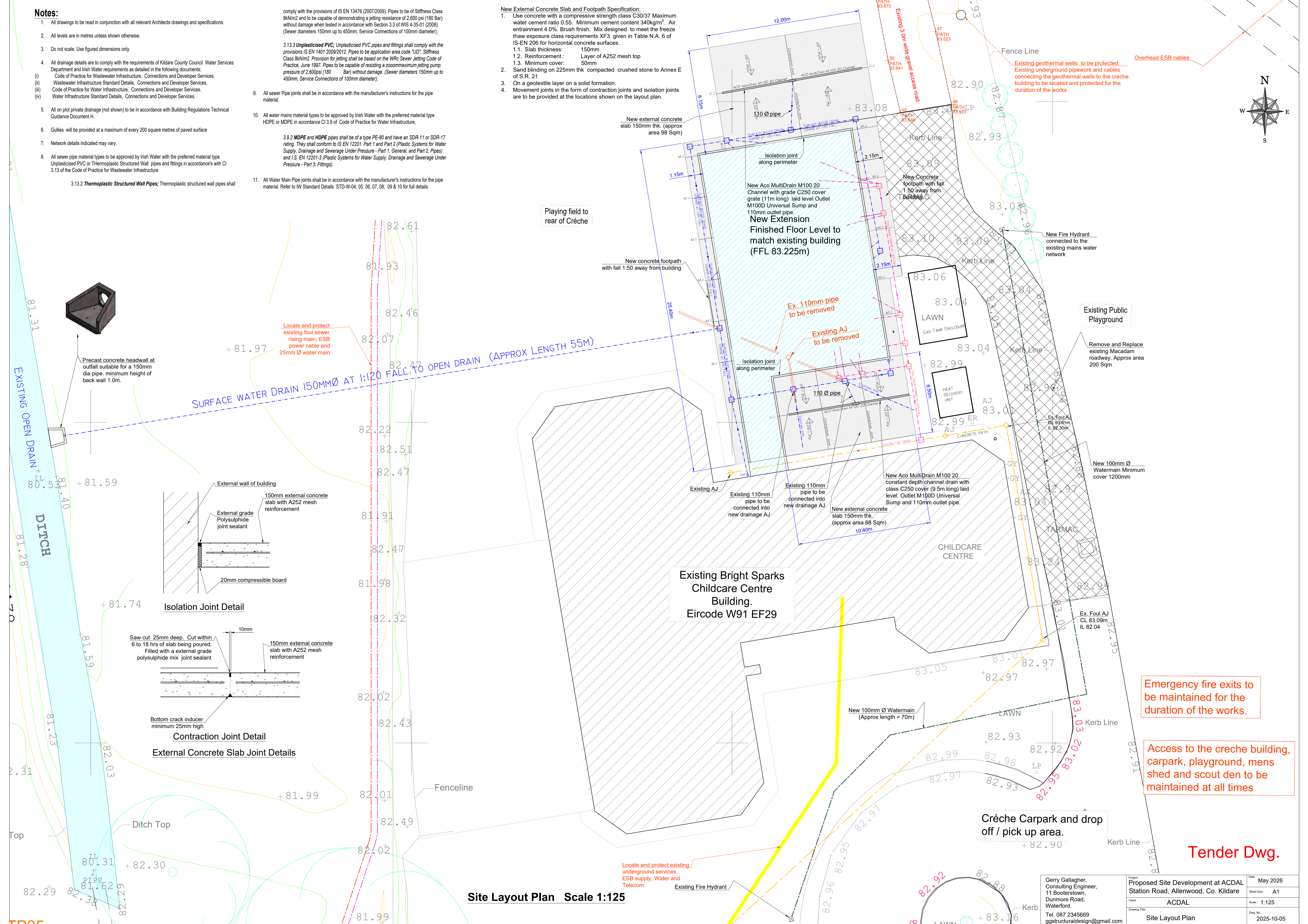

**Site Layout Plan Scale 1:125**

Gerry Gallagher, Consulting Engineer, 11 Booterstown, Dunmore Road, Waterford. Tel. 087 2345669 ggstructuraldesign@gmail.com	Project: Proposed Site Development at ACDAL Station Road, Allenwood, Co. Kildare	Date: May 2026
Client: ACDAL	Sheet No: 1:125	Scale: 1:125
Drawing Title: Site Layout Plan	Dep. No.:	2025-10-05

**Tender Dwg.**